

Hit-Air jacket / all-in-one airbag: Name and shape.

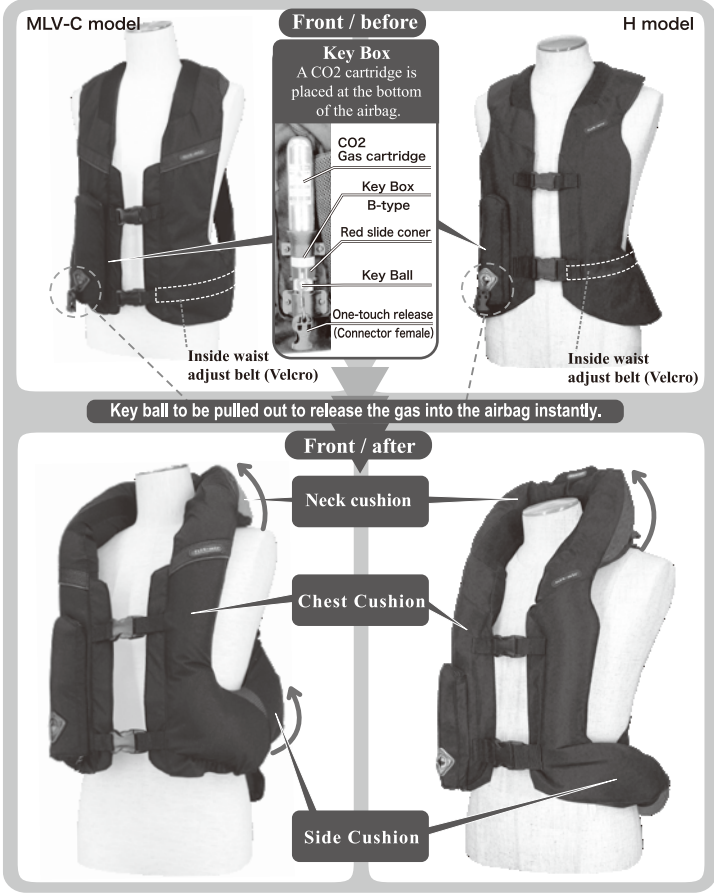

Key ball to be pulled out to release the gas into the airbag instantly.

*Design and shape of model may vary.

9

16

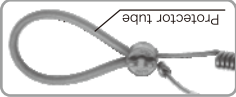

Protector tube
Made of such non-slippery materials as rubber or silicon to avoid abrasion of the part where the wire is tied.



The Loop Setter
The Loop Setter is used to secure the coiled wire after its length is adjusted. When you get on the horse, be sure that the butterfly screw has been screwed tightly. Place the coiled wire between the loop setter's grooves, and tighten the butterfly screw firmly. Leave about 2cm (0.8 inch) of the wire out of the loop setter after it has been tightened cut off any excess wire and put a cap on the end of the wire. Otherwise, a wire may come off the loop setter and the airbag will not be activated.

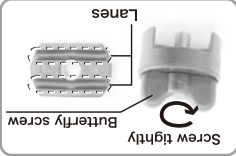

Loop setter
The Loop setter is used to secure the coiled wire after its length is adjusted. When you get on the horse, be sure that the butterfly screw has been screwed tightly. Place the coiled wire between the loop setter's grooves, and tighten the butterfly screw firmly. Leave about 2cm (0.8 inch) of the wire out of the loop setter after it has been tightened cut off any excess wire and put a cap on the end of the wire. Otherwise, a wire may come off the loop setter and the airbag will not be activated.

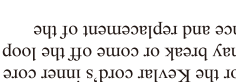

Coiled Wire
Is constructed with a strong wire made of Kevlar cord coated with urethane resin. The airbag will not be activated.

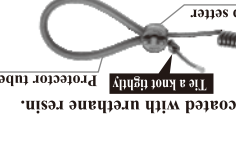

Coiled Wire
Is constructed with a strong wire made of Kevlar cord coated with urethane resin. The airbag will not be activated.

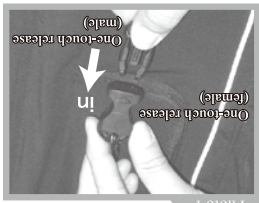
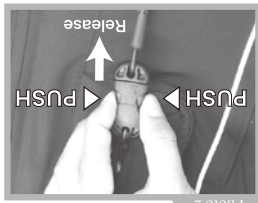

On the horseback, hold both sides of the female part of the "one-touch release" into which insert the male connector (Photo 1).
Before getting off the horse, press the press button of the "one-touch release" for disconnection (Photo 2).

5-2 Connecting Coiled Wire and Hit-Air

2. How to fix a coiled wire/bungee lanyard to the saddle strap.

Fix the coiled wire/bungee lanyard to the center loop of the saddle strap.

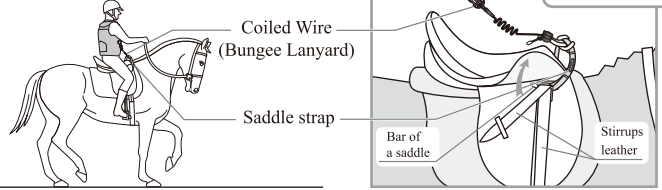

How to fix to the Saddle Strap.

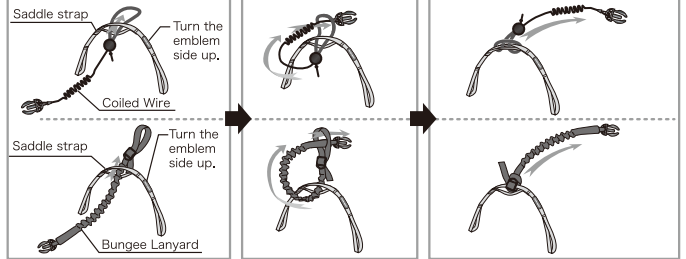

Pass the loop side of the coiled wire/bungee lanyard to the center loop of the saddle strap.
Pass the buckle side of the coiled wire/bungee lanyard to the other side's loop.
Pull the buckle side of the coiled wire/bungee lanyard until the other side's loop is tightly fastened to the saddle strap.

Saddle strap is to be fixed to the bar of the saddle.

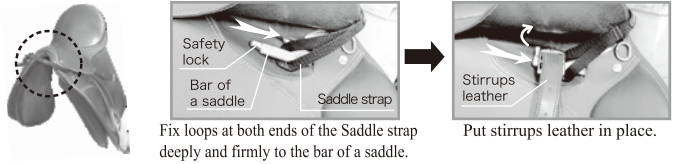

Fix loops at both ends of the Saddle strap deeply and firmly to the bar of a saddle.

Put stirrups leather in place.

- CAUTION 1. If the "coiled wire/bungee lanyard" is not attached to the saddle strap properly, it may come off when it is stretched then the Hit-Air will not be activated.
- CAUTION 2. Replace the "coiled wire/bungee lanyard" when wear, burns, peeling or cracks are found. *Do not use the coiled wire/bungee lanyard other than the one supplied by an authorized dealer.
- CAUTION 3. Don't use a frayed and deteriorated saddle strap. Replace it immediately, otherwise it may be worn out and the system may not be activated.
- CAUTION 4. The saddle strap connected to the bar of a saddle may come off at the activation and the airbag may not inflate

18

11

4-2 Air Cushion

1. The air cushions are made of high quality strong urethane film to absorb and reduce the shock of impact as much as possible when they are swollen.
2. The maximum pressure is about 30kpa(0.3kg/cm²) when the air cushion is fully inflated, but gradually decreases as gas comes out of the air cushion.
3. The strength against breakage depends on the material of the jacket the material of the inner tube (urethane) and the strength of the stitch it also depends on the degree of impact, shape or hardness of the object the rider may hit after the Hit-Air inflates.
4. The gas is sent from the "key box" to each air cushion through urethane tubing. The Hit-Air is designed to act as a shock absorber and may break depending on the shape of the object against which it strikes and also the extent of impact given.

CAUTION 5. Whenever the Hit-Air is inflated, even if there is no visible damage, we recommend taking the Hit-Air to an authorized dealer for a maintenance check.
* Even if no damage is visible, there may be damages to the air cushion. Therefore, take the Hit-Air to an authorized dealer for a maintenance check to test the air cushion for leaks and inspect its parts to make sure it will function properly in case of an accident.

1. As soon as the "activation distance" is reached, the Hit-Air is activated and the CO₂ gas is sent into the air cushions so that it will provide protection from the shock of impact even before it is fully inflated.
2. The CO₂ gas cartridge and the "key box" area is covered by an ABS protector with buffer material to protect the rider's breast from the projecting objects in case of an accident.
3. After the airbag is inflated in full, the gas will leak out gradually. Depending on the amount of the pressure given to the airbag by the accident, a feeling of tightness may be felt but gradually subsides.

4-1 Function