

5-1 One-touch Release

Use the “one-touch release” for easy connection or disconnection of the “coiled wire” attached to the motorcycle and the “key ball” inserted in the “key box”.

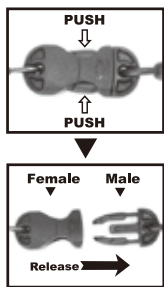

CAUTION ⚠

1. The one-touch release may come in contact with and cause damage to the tank or other part of the motorcycle. If such situation is expected, putting a seal around such parts for protection is recommended.
2. Hold the female connector and insert the male one. A clicking sound will confirm that a connection is made properly. Otherwise, it may come off by itself.
3. Change the connectors if the connection is not made properly. Additional force to connect/disconnect the one-touch release may cause damage or malfunction.
4. When getting off the motorcycle, make sure that the male part does not touch the hot part of the motorcycle, such as the engine or muffler, because the heat could damage the optimal shape of the male part.

5-2 Connecting Coiled Wire and Hit-Air

- Hold both sides of the female part of the “one-touch release” and insert the male connector (Photo 1).
- Before getting off the motorcycle, press the press button of the “one-touch release” for disconnection (Photo 2).

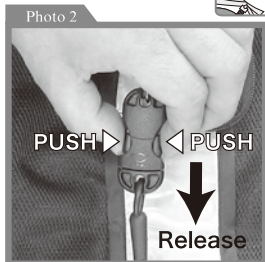
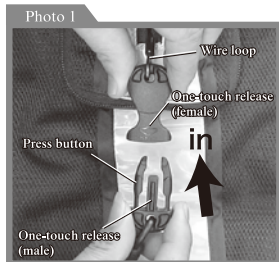
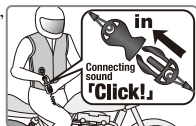

*Shape and how to use the “one-touch release” may be different from the Photos 1 and 2.

WARNING ⚠ Before riding the motorcycle, make sure the red guard on the “key box” is in the ‘unlocked (up)’ position (see page 12, photo 2). If it is in the ‘locked (down)’ position, the Hit-Air will not work properly in case of accident etc.

4-3 Key Box

○ **Key Box**
The “key ball” comes out from the “key box” when it was pulled by a certain tensile force. Then a needle in the “key box” is activated and punctures the seal of the gas cartridge to inflate the Hit-Air instantly. The “key ball” can be pulled out from any direction (Photo 1).

WARNING ⚠ 1.
Do not take the “key box” apart or remove any parts.

○ **Red guard**
Whenever using the Hit-Air, make sure the red guard is in the ‘unlocked’ (up) position. (Photo 2)

To re-assemble the key box, the red guard is to be used to confirm that the key ball is properly set in the hole of the key box. (Photo 3)
If the key ball is not set in the hole properly, the red guard will not come down.

WARNING ⚠ 1.
When the red guard is in the ‘locked’ (down) position, the “key ball” cannot be released from the “key box”, then the Hit-Air will not be activated. This may cause an injury to the rider in case of an accident. Whenever using the Hit-Air, make sure the red guard is in the ‘unlocked’ (up) position. (Photo 2)

CAUTION ⚠ 2.
Even if the red guard is in the ‘locked’ position, if the wire is pulled strongly, the “key box” may activate the Hit-Air to inflate.

