

Hit-Air jacket / all-in-one airbag: Name and shape.

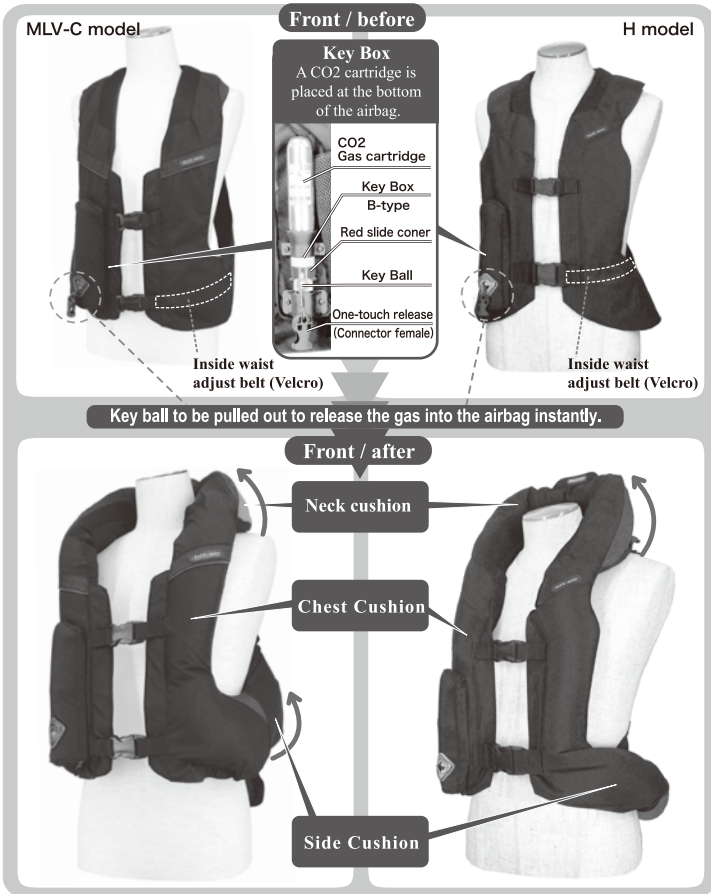

*Design and shape of model may vary.

9

2. How to fix a coiled wire to the saddle strap.

Fix the coiled wire to the center loop of the saddle strap.

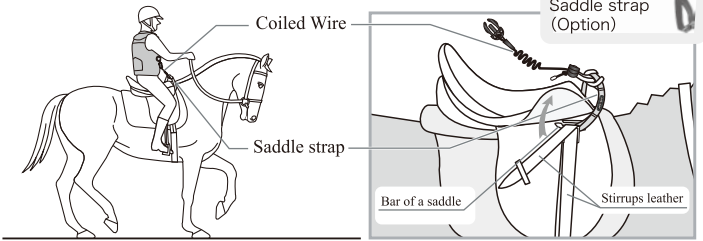

How to fix a coiled wire to the Saddle strap.

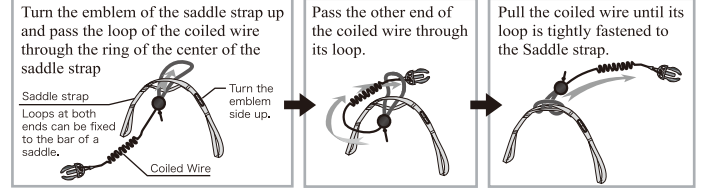

Saddle strap is to be fixed to the bar of a saddle of the saddle.

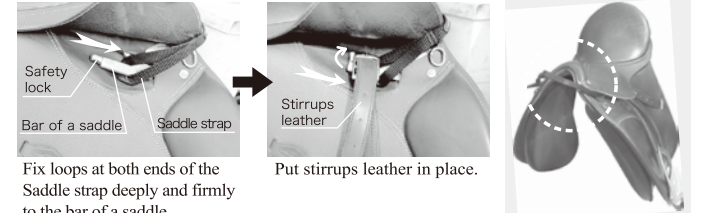

- CAUTION 1. If the "coiled wire" is not attached to the saddle strap properly, it may come off when it is stretched then the Hit Air will not be activated.
- CAUTION 2. Replace the "coiled wire" when wear, burns, peeling or cracks are found. *Do not use the coiled wire other than the one supplied by an authorized dealer.
- CAUTION 3. Don't use a frayed and deteriorated saddle strap. Replace it immediately, otherwise it may be worn out and the system may not be activated.
- CAUTION 4. The saddle strap connected to the bar of a saddle may come off at the activation and the airbag may not inflate

18

16

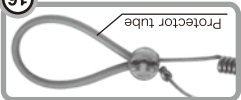

Protector tube
Made of such non-slippery materials as rubber or silicon to avoid abrasion of the part where the wire is tied.



Loop setter
The Loop Setter is used to secure the coiled wire after its length is adjusted. When you get on the horse, be sure that the butterfly screw has been screwed tightly.

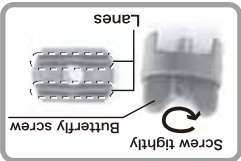

Loop setter
The Loop Setter is used to secure the coiled wire after its length is adjusted. When you get on the horse, be sure that the butterfly screw has been screwed tightly.

Coiled Wire
It is constructed with a strong wire made of Kevlar cord coated with urethane resin. It is constructed with a strong wire made of Kevlar cord coated with urethane resin.

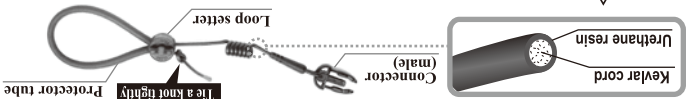

Coiled Wire
It is constructed with a strong wire made of Kevlar cord coated with urethane resin.

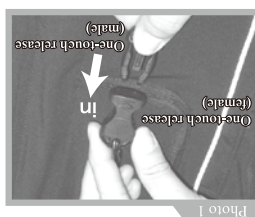
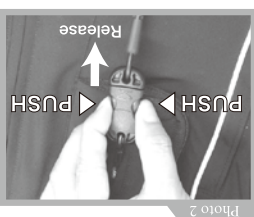

- On the horseback, hold both sides of the female part of the "one-touch release" into which insert the male connector (Photo 1).
- Before getting off the horse, press the press button of the "one-touch release" for disconnection (Photo 2).

5-2 Connecting Coiled Wire and Jacket with Hit-Air

4-2 Air Cushion

1. The air cushions are made of high quality strong urethane film to absorb and reduce the shock of impact as much as possible when they are swollen.
2. The maximum pressure is about 30kpa(0.3kg/cm²) when the air cushion is fully inflated, but gradually decreases as gas comes out of the air cushion.
3. The strength against breakage depends on the material of the jacket the material of the inner tube (urethane) and the strength of the stitch it also depends on the degree of impact, shape or hardness of the object the rider may hit after the Hit-Air inflates.
4. The gas is sent from the "key box" to each air cushion through urethane tubing. The Hit-Air is designed to act as a shock absorber and may break depending on the shape of the object against which it strikes and also the extent of impact given.

CAUTION 1. Even if no damage is visible, there may be damages to the air cushion. Therefore, take the Hit-Air to an authorized dealer for a maintenance check to test the air cushion for leaks and inspect its parts to make sure it will function properly in case of an accident.

CAUTION 2. The Hit-Air may not function properly, if there is a damage to the Hit-Air, cloth of the wear, air cushion, Velcro, zipper, buckle etc. If so, consult with an authorized dealer.

1. As soon as the "activation distance" is reached, the Hit-Air is activated and the CO₂ gas is sent into the air cushions so that it will provide protection from the shock of impact even before it is fully inflated.
2. The CO₂ gas cartridge and the "key box" area is covered by an ABS protector with buffer material to protect the rider's breast from the projecting objects in case of an accident.
3. After the airbag is inflated in full, the gas will leak out gradually. Depending on the amount of the pressure given to the airbag by the accident, a feeling of tightness may be felt but gradually subsides.

4-1 Function

11