

## 5-4 How to fix a Coiled Wire

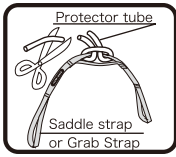

**1** Turn the emblem of the saddle strap (or Grab Strap) up, wind a protector tube around the upper side of the center of the saddle strap and cut the excess tube.

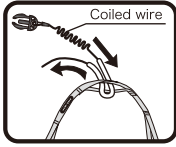

**2** Pass a coiled wire through the protector tube.

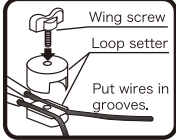

**3** Temporarily fix the coiled wire outside the protector tube in the loop setter and adjust its length.

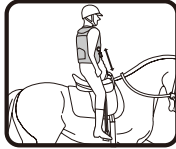

**4** Stand up on the stirrups to make the coiled wire fully stretched to determine the optimum length of the coiled wire.

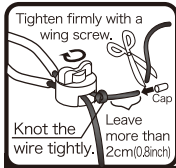

**5** Fix the coiled wire firmly in the loop setter, tie a knot in its end and cut off the excess, leaving more than 2cm (0.8 inch) of extra length and put a cap on the cut end.



**2.** Pass a wire through the loop. **3.** Knot tightly. Leave more than 2cm (0.8inch) closely.



### Where to fix the saddle strap

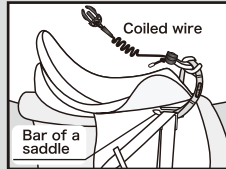

### How to adjust the length of a coiled wire.

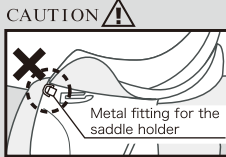
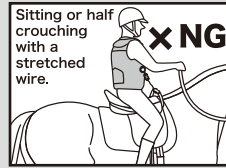
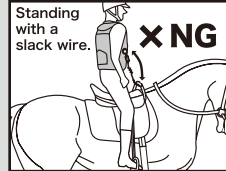
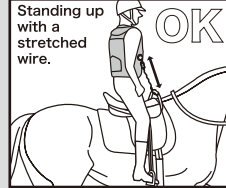

Don't fix a coiled wire directly to metal fittings for the grab strap which may be broken or may come off and the system may not activate.

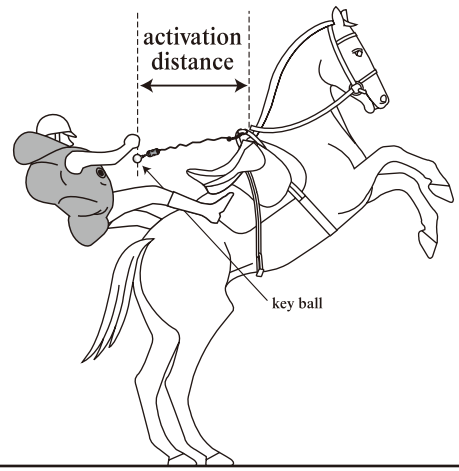

- If the "coiled wire" running from the "key box" to the saddle holder touches an obstacle such as the rider's body, any part of the saddle, a whip or any other projecting object, there is a possibility of accidental activation within the "activation distance" by a force strong enough to pull the "key ball" out of the "key box".
- If the rider crashes or falls down together with the horse, unless the "activation distance" is exceeded, the Hit-Air will not be activated. The Hit-Air will not protect areas where the inflated air cushion does not cover.
- If the rider wearing the Hit-Air forgets to disconnect the "one-touch release" and goes away from the horse further than the "activation distance", a force of approximately 30kg-35kg (See 4.3 P12) may activate and inflate the Hit-Air. Connect or disconnect the "one-touch release" while you are on the horse.
- Once a gas cartridge is used, it cannot be used again. Buy a new one from an authorized dealer.

10

\*Design and shape of model may vary.

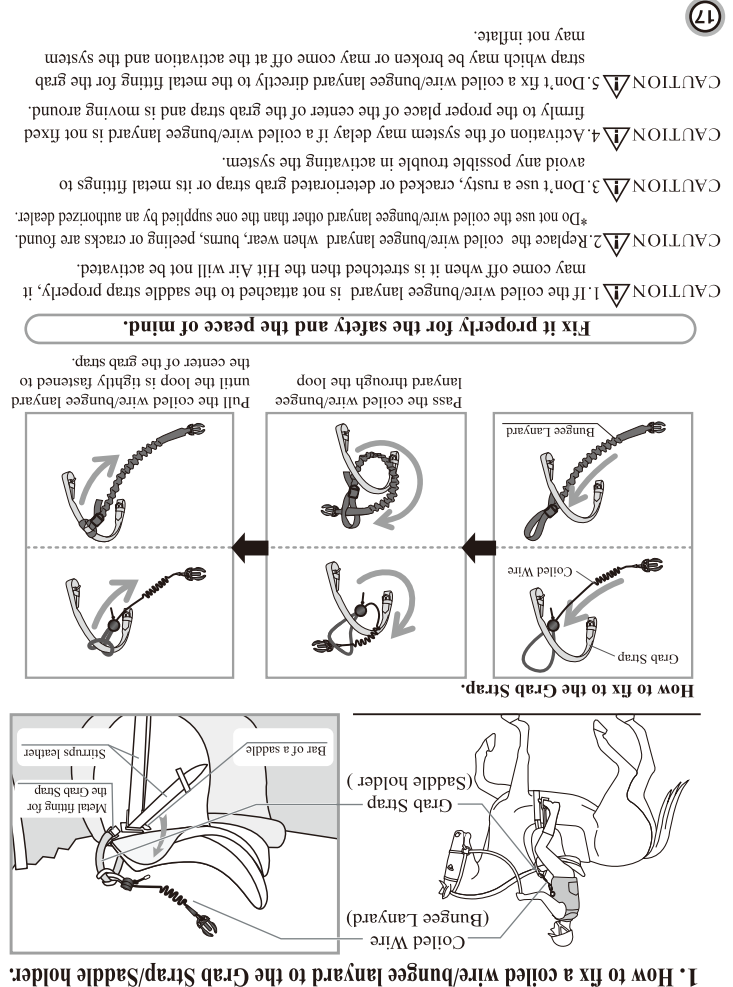
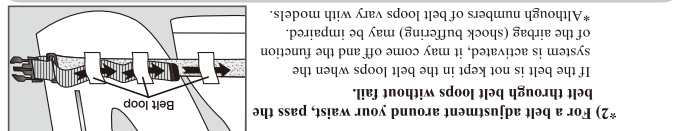
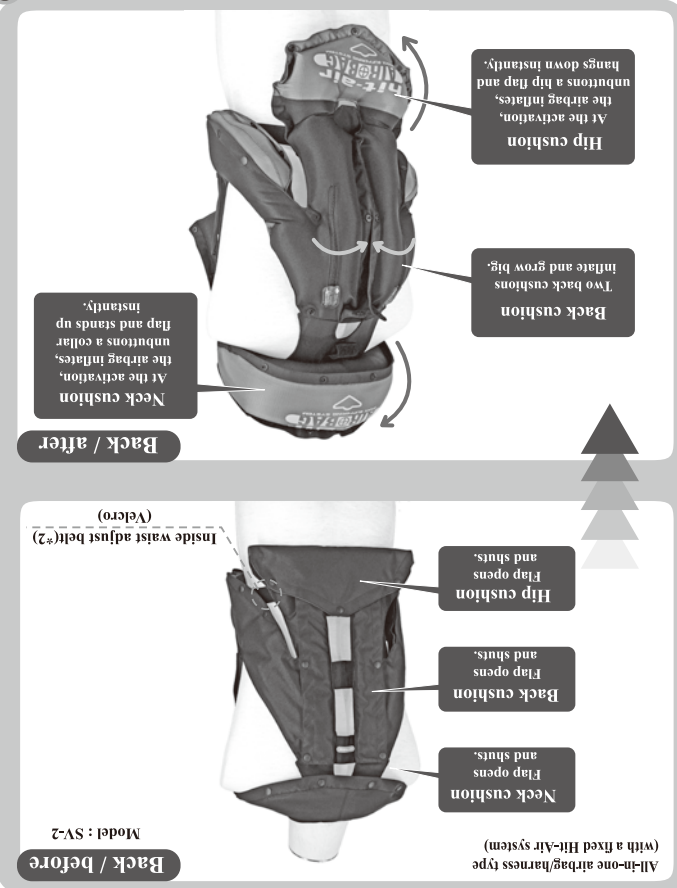

## 5-3 Attaching Coiled Wire/Bungee Lanyard to Saddle

8

17