

⚠ Be sure to read this page before using and after re-assembling the Hit-Air.

Thank you for using the Hit-Air.

For your safety, peace of mind and correct use of your airbag jacket, make sure that items ①-⑥ are confirmed before use as follows:

Caution ⚠

- Unless the Hit-Air is set correctly, it may not work or may cause a malfunction.
- Once a Hit-Air CO2 gas cartridge is activated, it cannot be used again. Remove it from the key box without fail.
- Use a Hit-Air CO2 gas cartridge only. Do not use any other one.

① A Hit-Air CO2 gas cartridge of the right size (capacity) for the model is installed.

The sticker attached the cartridge shows its size (capacity).

② Install the Hit-Air CO2 gas cartridge properly.

- The right size (capacity) cartridge for the model is installed.
- A Hit-Air CO2 gas cartridge is tightly screwed into the key box.
- A used/empty cartridge should not be installed.

Caution ⚠ Re-assembling after the activation must be done in accordance with "Re-assembling Key Box" (see page 21 to 24). The used cartridge must be taken out after the key ball is reset.

③ The red guard is lifted to the "unlocked" (up) position.

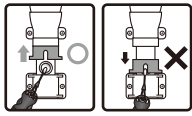

④ Is there any deterioration of the wire loop or the coiled wire?

⑤ A screw hole at the bottom of the key box is visible.

(The setting bolt is removed)

⑥ A coiled wire is set properly.

See "Attaching Coiled wire to Motorcycle" (page 16 to 18)

⚠ Be sure to tie a knot tightly.

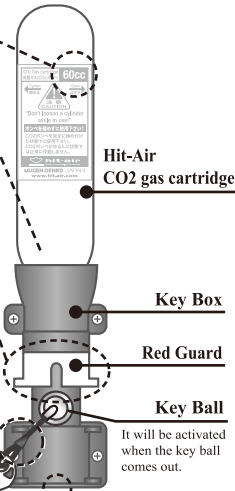
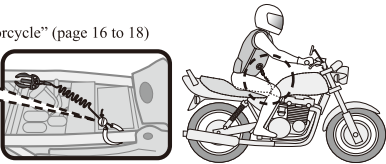

①

②



Photo 12

Screw an unused cartridge as indicated on the sticker attached to the cartridge.



Photo 11

12. Take the connector out through the hole of the key box cover. Close the zipper around the key box. (Photo 12)

CAUTION ⚠ If the cartridge is not seated completely and firmly, the Hit-Air may not be activated/inflated.

11. Screw a new CO2 cartridge. (Photo 11) Please confirm if the seal of the cartridge is not punctured and it's new.

▶▶ 10 Change

If a problem listed below is found on the Hit-Air, consult with an authorized dealer to change or repair/replace.

1. Fabric part becomes frayed or torn. And/or the inner tube (white polyurethane film) is exposed.
2. A crack or rust is found on the "key box" or on the gas cartridge.
3. The "coiled wire" or the "wire loop" gets scraped and frayed.
4. Considerable change of color or deterioration of material is found.

②6

③

- ▶▶ 1 Safety Precautions 5
- ▶▶ 2 General Information 7
- ▶▶ 3 Name and Shape 9
- ▶▶ 4 Structure 11
- ▶▶ 4-1 Function 11
- ▶▶ 4-2 Air Cushion 11
- ▶▶ 4-3 Key Box 12
- ▶▶ 4-4 Key Ball 13
- ▶▶ 4-5 Hit-Air Structure 13
- ▶▶ 4-6 Hit-Air CO2 gas cartridge 14
- ▶▶ 5 Using Hit-Air 15
- ▶▶ 5-1 One-touch Release 15
- ▶▶ 5-2 Connecting Coiled Wire and Hit-Air 15
- ▶▶ 5-3 Attaching Coiled Wire to Motorcycle 16
- ▶▶ 5-4 Where and how to fix a Coiled Wire 17
- ▶▶ 6 Attention after Activation 19
- ▶▶ 7 Re-assembling Hit-Air after Activation 20
- ▶▶ 7-1 How to Re-assemble 20
- ▶▶ 7-2 Re-assembling Key Box 21
- ▶▶ 8 Washing 25
- ▶▶ 9 How to Store 25
- ▶▶ 10 Change 26

○ Thank you for your purchase.
○ For the proper use of the Hit-Air, please read this booklet carefully before use.
○ Please carry this booklet whenever you use the Hit-Air.