

As soon as a rider is thrown away from the motorcycle, the airbag will be deployed.

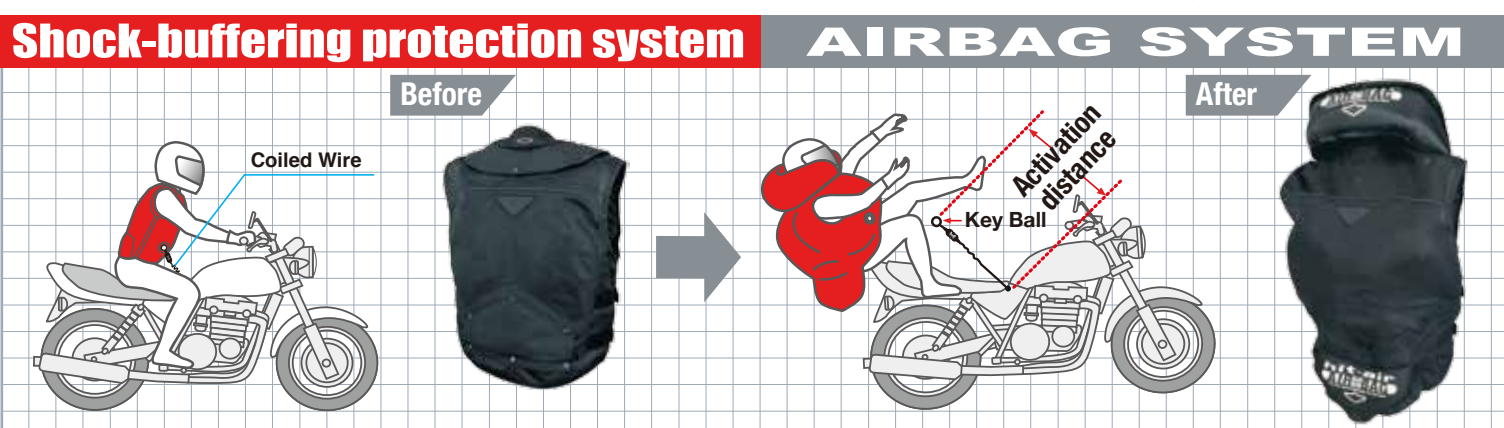

In a fall or crash, the shock-buffering protection system will be activated instantly after the distance from the rider to the motorcycle exceeds the "activation distance", when the key ball is pulled out of the key box to release CO2 gas into the neck, back, chest, side and hip airbags to inflate them and to absorb the impact on rider's body.



**S-SYSTEM "S-System" Speed up of airbag deployment!**  
 S-System is an improved key box (a device to activate the airbag system) cutting the deployment time (from activation to full inflation of the airbag) in half!

Ordinary system	S-SYSTEM
Deployment time <b>about 0.5 second</b>	Deployment time <b>about 0.25 second</b>
Ordinary system Key Box Color : Black	S-system Key Box Color : Gray

\*Deployment time may vary depending on the model and the conditions of use (temperature etc.)

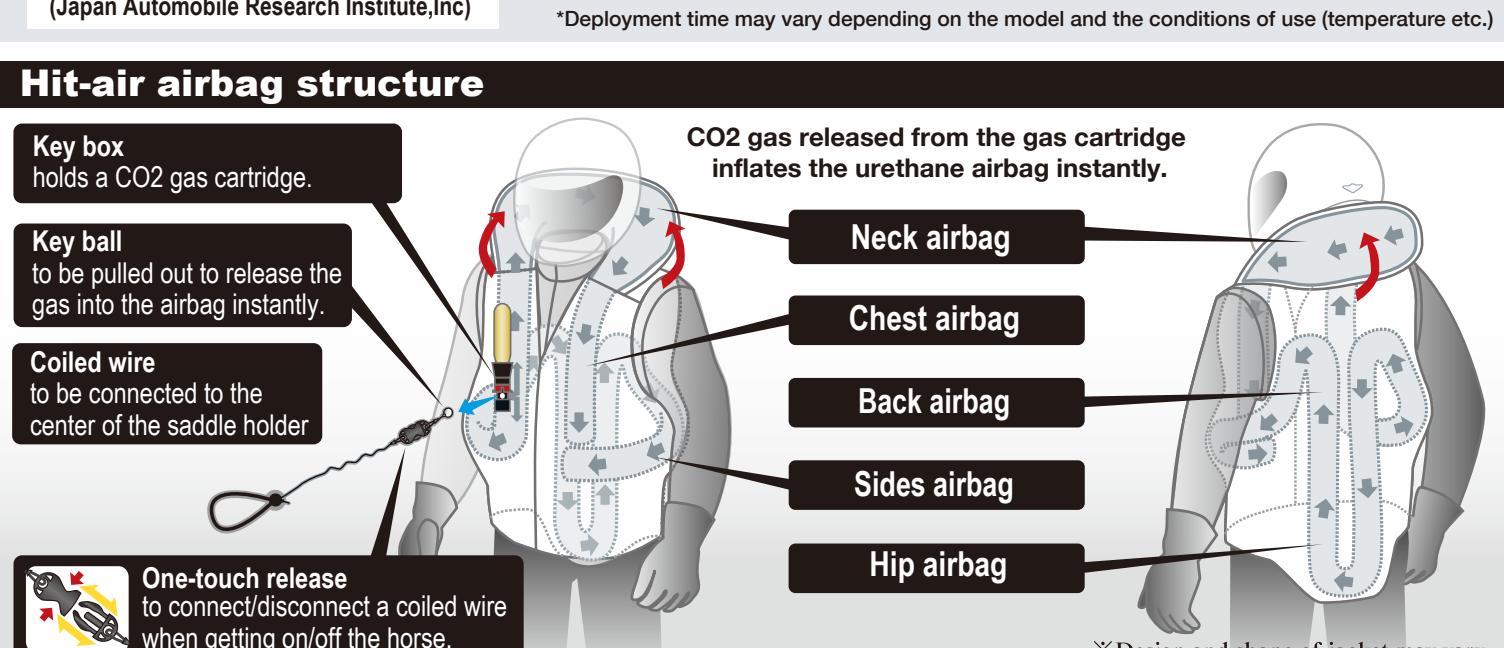

**How to hit-air**  
 The jacket with the Hit-air (Shock-buffering Protection System) is to be worn as an outerwear when riding a motorcycle.

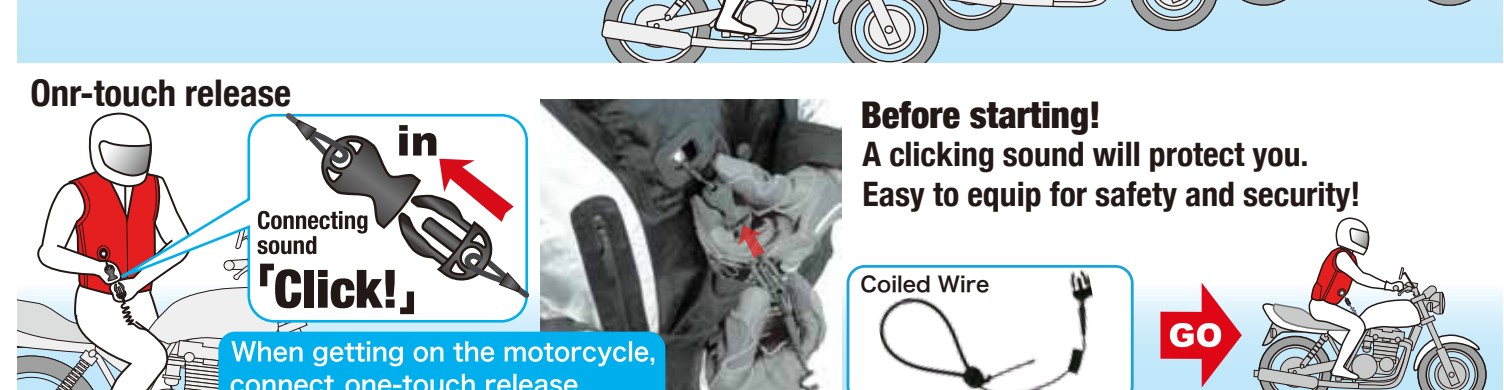

**Hit-air can be re-used repeatedly.**  
 Unless it is damaged by the previous activation, it can be re-used by replacing the CO2 cartridge.

\* Do not reuse the gas cartridge once used.  
 A CO2 cartridge with a hole at the bottom is unusable.

**Re-assembling airbag(Key Box)**

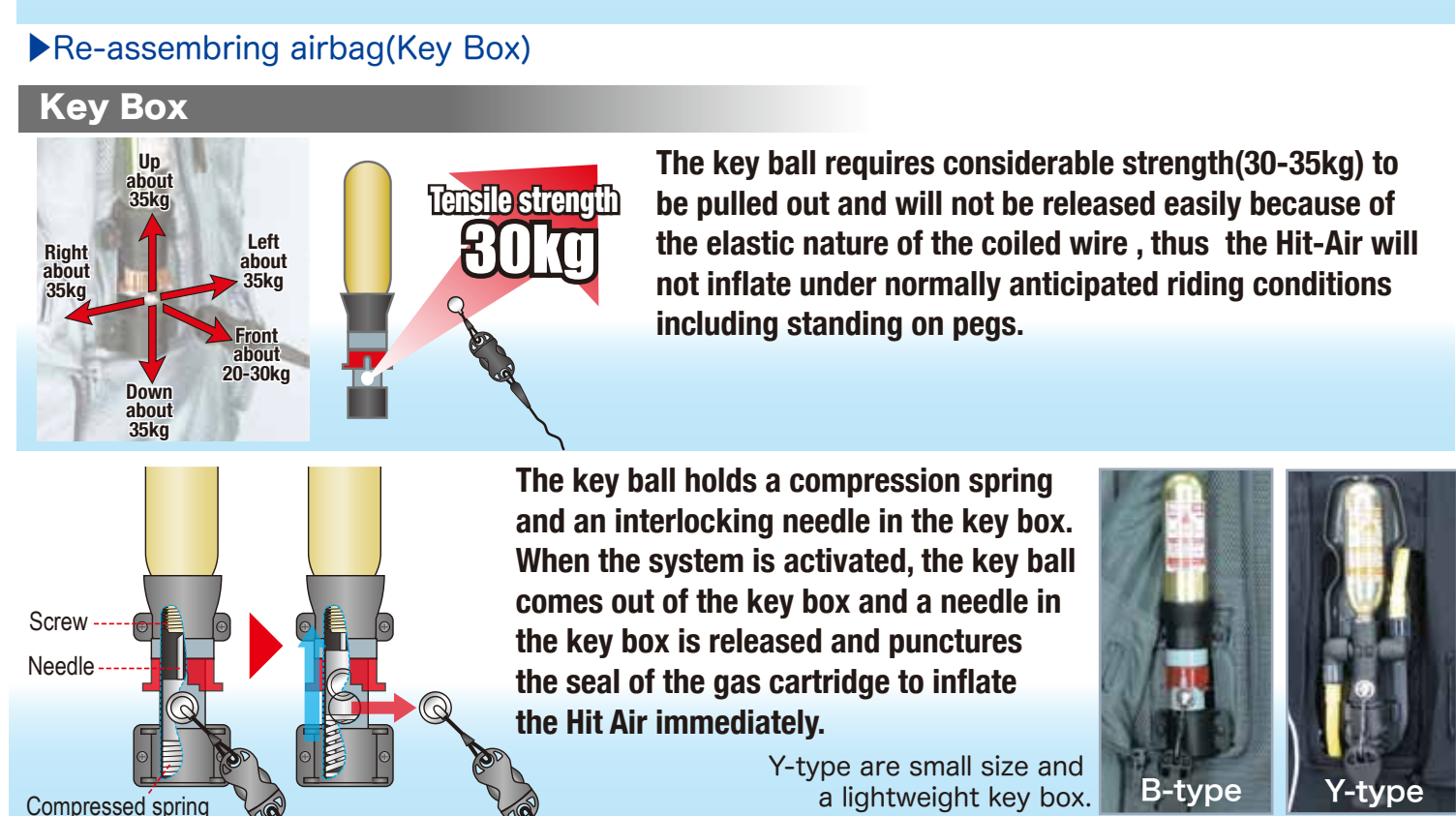

**Structure and kind of airbag**

**airbag jacket - vest**  
 An airbag system is installed in the jacket. (Detaching airbag system)  
 CE approved shoulder and elbow padding is standard equipment.  
 Soft type back padding is fitted as standard equipment.  
 This models features various functions appropriate to the season.

**airbag vest**  
 An airbag system is installed in the vest. (Detaching airbag system)  
 Wearable over an ordinary jacket or a raincoat.  
 Mesh makes it comfortable to wear in any season.  
 Soft type back padding is fitted as standard equipment.

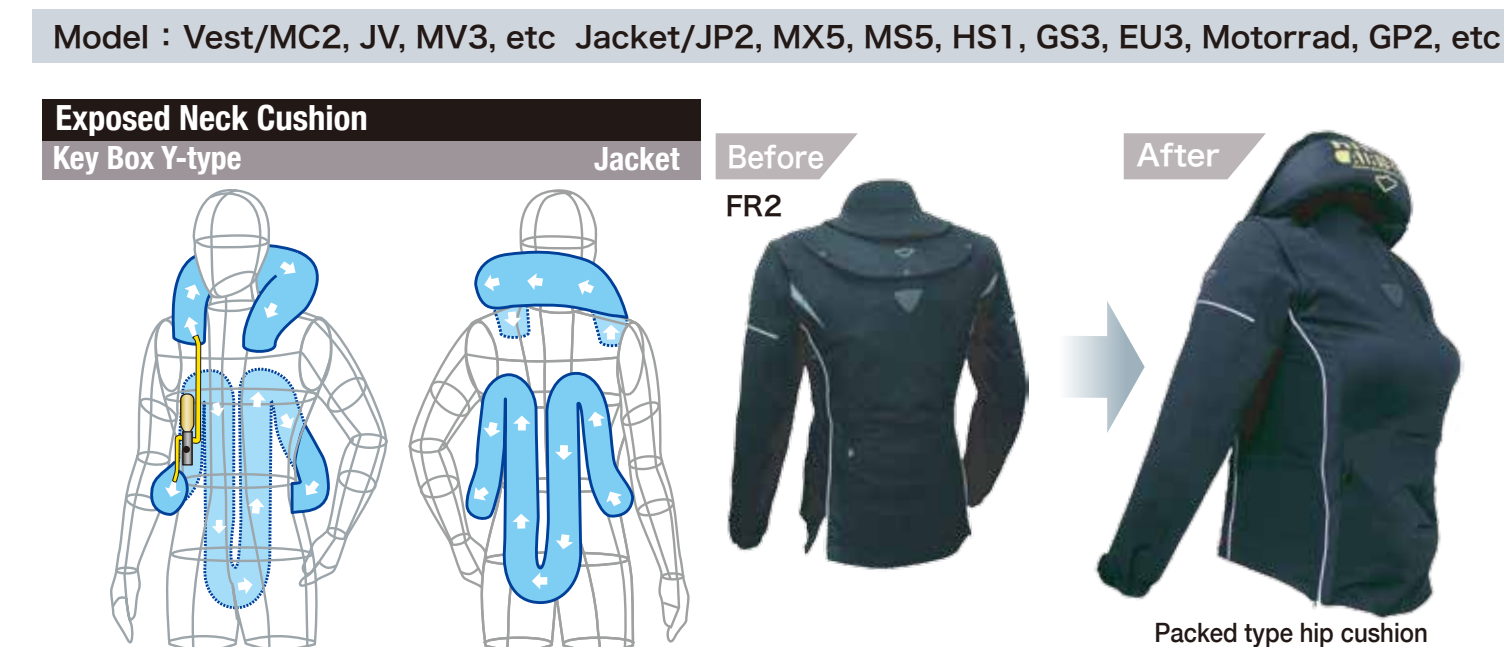
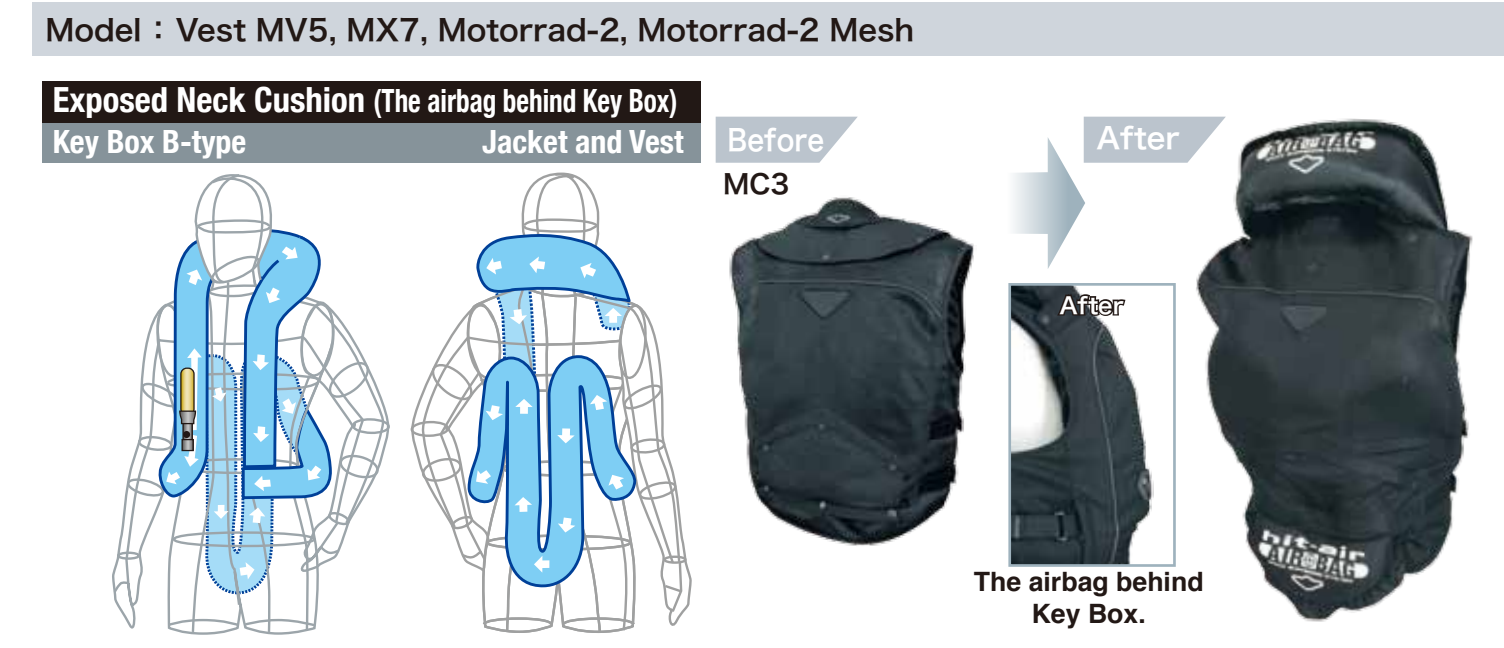

**airbag system protector**

**all-in-one airbag**  
 Wearable over an ordinary jacket or a raincoat. Designed to minimize contact area with the jacket.  
 Adjust the size using a waist adjuster. Wearable as a protector in any season.



**race model airbag system**

The airbag system for a track suit to absorb the shock of impact of a fall on the head and neck in the race etc.  
 The key box is placed on the back to prevent the coiled wire from disturbing rider's movements.



**neck airbag**

A shock-buffering system to protect the neck. Wearable over an ordinary jacket or a raincoat.  
 Adjust the size using an adjustable side-belt. Wearable as a protector in any season.



Hit-air airbag system

- S-SYSTEM
- Airbag structure
- How to hit-air
- ヒットエアアの仕組みと使い方
- ヒットエアアの着用方
- ワンタッチリリース
- エアバグの再利用
- キーボールの強さ
- Structure and Type of KeyBox
- Coiled Wire
- Structure and Type of Airbag
- ジャケット・ベスト/B型
- ジャケット/Y型
- ベスト/Y型
- ジャケット/首気室収納型
- Coming soon
- 一体型エアバグ・ハーネス
- 首部エアバグ・ハーネス